

RP

ROSBOROUGH
PARTNERS, INC.

SINCE 1991



Transforming Landscapes...Transforming Lives

CULTIVATE

July 10, 2023

Shelter From The Elements



With summer in full swing, you might be looking for ways to enjoy the season outdoors in comfort. There is an endless variety of structures and styles to meet your needs and aesthetic. Imagine sipping morning coffee with the singing birds, working remotely with a view of the garden, or dining with family in the fresh air.



Slatted cover overhead can give relief from the bright sun, while a solid roof allows you to take in a summer rain. Or if you're looking for a little extra gathering or work space, three-season rooms and gazebos add usable square footage as flex space to meet your needs in the moment.

Contact our Design Department to start your summer structure project, and feel the calming effect of time spent immersed in nature.

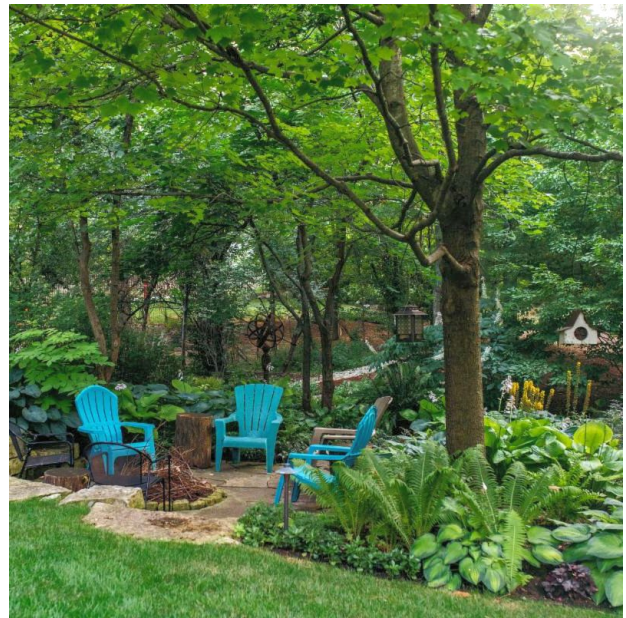

Garden Steward Team

In addition to regularly scheduled maintenance services, this week our team will be focused on the following:

Finishing summer pruning

Plant Health Care

The PHC team will be applying the following treatments as weather allows:

Rose care

Animal repellent

Mosquito abatement

Ornamental insecticide

Weed control for turf

Contact Information

Feel free to contact your Garden Steward directly with any questions or requests for service. Or

contact our office 847/549-1361, Monday-Friday, 8:30am-5:00pm.

NOTE: We continue to respect physical distancing protocols for staff and client safety until further notice.

Design Team

Joe Haubert: 847/514-8376 / joseph@rosboroughpartners.com

Chris Durley: 847/774-2006 / chris@rosboroughpartners.com

Taylor Lininger: 847/417-0834 / taylor@rosboroughpartners.com

Erika Plascencia: 847/343-7403 / erika@rosboroughpartners.com

Matt Johnson: 224/612-3319 / matt@rosboroughpartners.com

Garden Steward Team

Jose Mercado: 847/417-0841 / jose@rosboroughpartners.com

Katie Belleno: 847/732-1927 / katie@rosboroughpartners.com

Terri Thornton: 847/514-8455 / terri@rosboroughpartners.com

Gabe Mercado: 847/417-4350 / gabe@rosboroughpartners.com

Bill Marty: 224/471-7904 / wmarty@rosboroughpartners.com

Plant Health Care

Lucio Torres: 847/417-1618 / lucio@rosboroughpartners.com

Chief Steward Officer

Phil Rosborough: 847/417-0832 / phil@rosboroughpartners.com

Rosborough Partners Inc | rosboroughpartners.com



Rosboroughpartners, Inc. | 342 N. 4th St., Suite 104, Libertyville, IL 60048

[Unsubscribe becky@rosboroughpartners.com](mailto:becky@rosboroughpartners.com)

[Update Profile](#) | [Constant Contact Data Notice](#)

Sent by becky@rosboroughpartners.com powered by



Try email marketing for free today!